

Terminal	SYMBOL
1	GND
2	VCC
3	SCL
4	SDA

*1. Display Type	Positive Matrix
*2. Display Color	Monochrome(White)
*3. LCD Driver Mode	1/64Duty
*4. Operating Voltage	5.0V
*5. Operating Temp	-40°C~85°C

*6. Storage Temp	-40°C~90°C
*7. Driver IC	SSD1315
*8. RHHS	

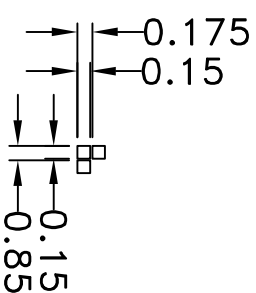

DOT DETAIL
SCALE 5:1

HOT DISPLAY

Dwg Title: HTM-DLED0.96-12C-04A

EDC No: Ver: A/0

Scale: 1:1 Unit: mm Tol: ±0.3

Drawn: Checked: Date: 2024-10-16